

S.A. cylinder-serie r (with head bush)

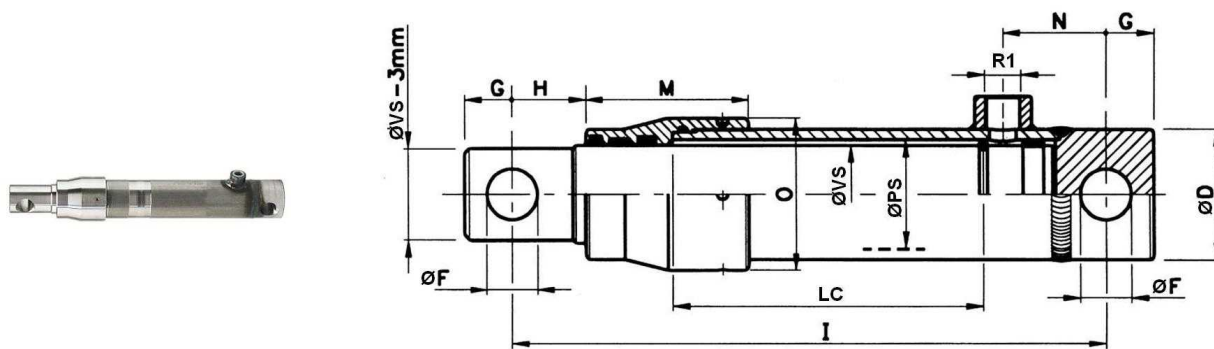

Maximum work pressure 210 bar

Temperature -30°C a 110°C

Part nº	R1	Kg/100 bar	Piston rod	ØPS	Stroke (mm)	ØD	ØF	G	H	I	M	N	O
SE45200	3/8" BSP	1590	45	50 H9	200	60	23,4	22	34	330	75	47	70
SE45300	3/8" BSP	1590	45	50 H9	300	60	23,4	22	34	430	75	47	70
SE45400	3/8" BSP	1590	45	50 H9	400	60	23,4	22	34	530	75	47	70
SE45550	3/8" BSP	1590	45	50 H9	550	60	23,4	22	34	680	75	47	70
SE45700	3/8" BSP	1590	45	50 H9	700	60	23,4	22	34	830	75	47	70
SE50200	3/8" BSP	1960	50	55 H9	200	65	25,5	25	49	360	80	50	75
SE50300	3/8" BSP	1960	50	55 H9	300	65	25,5	25	49	460	80	50	75
SE50400	3/8" BSP	1960	50	55 H9	400	65	25,5	25	49	560	80	50	75
SE50550	3/8" BSP	1960	50	55 H9	550	65	25,5	25	49	710	80	50	75
SE50700	3/8" BSP	1960	50	55 H9	700	65	25,5	25	49	860	80	50	75
SE55300	3/8" BSP	2370	55	60 H9	300	70	25,5	25	41	460	95	50	85
SE55550	3/8" BSP	2370	55	60 H9	550	70	25,5	25	41	710	95	50	85
SE55700	3/8" BSP	2370	55	60 H9	700	70	25,5	25	41	860	95	50	85
SE60200	3/8" BSP	2820	60	65 H9	200	75	25,5	25	36	360	95	50	89
SE60300	3/8" BSP	2820	60	65 H9	300	75	25,5	25	36	460	95	50	89
SE60400	3/8" BSP	2820	60	65 H9	400	75	25,5	25	36	560	95	50	89
SE60550	3/8" BSP	2820	60	65 H9	550	75	25,5	25	36	710	95	50	89
SE60700	3/8" BSP	2820	60	65 H9	700	75	25,5	25	36	860	95	50	89

*** Review attached PDF***